

# HYDRODUCT<sup>®</sup> 660 Data Sheet

High impact, creep-resistant drainage composite and protection layer for use with GCP waterproofing membranes in all horizontal applications

## Product Description

HYDRODUCT<sup>®</sup> 660 is a highly robust, preformed, 0.44 in. (11 mm) thick geocomposite drainage sheet system, comprising a dimpled polymeric core with a heavy-duty nonwoven geotextile bonded to the dimple side and a polymeric film bonded to the back side. This film allows the HYDRODUCT<sup>®</sup> 660 to be placed against waterproofing membrane and should not be removed.

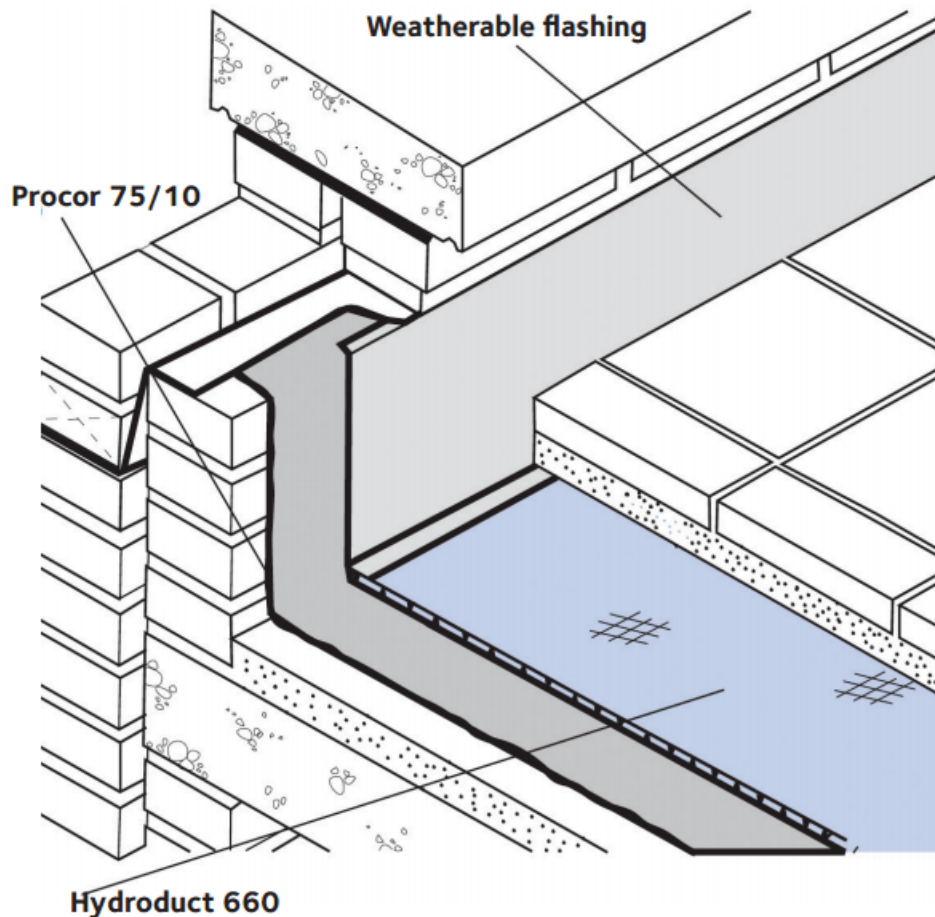

## Uses

HYDRODUCT<sup>®</sup> 660 Drainage Composite is designed to collect and transport water to drainage outlets. It can be used on all horizontal applications regardless of the type of overburden and serves as a combination drainage and protection course for all GCP waterproofing membranes.

The high strength, nonwoven geotextile is designed to maintain permeability while protecting the drainage composite from job site damage prior to, and during, the installation of the overburden. The high permittivity of the nonwoven geotextile facilitates the removal of water from a concrete pour, thus enhancing the concrete cure, as well as providing drainage after installation. The geotextile is securely bonded to the core to prevent intrusion of the fabric into the core during service. The high modulus backing film ensures compatibility when used with either PROCOR<sup>®</sup> fluid applied waterproofing membranes, or with BITUTHENE<sup>®</sup> waterproofing membranes.

## Product Advantages

- Universal horizontal application—suitable for all overburdens including concrete
- Damage and creep-resistant—high compressive strength core resists traffic loads and site damage to maintain drainage flow
- High flow capacity
- Enhances waterproofing—eliminates hydrostatic head build up
- Securely bonded fabric—restricts intrusion into core Polymeric backing film—compatible with both sheet and liquid waterproofing membranes
- Lightweight—easy to install without special equipment
- Simple, convenient, drainage and protection layer—robust membrane protection

## Application Procedures

### Safety, Storage and Handling Information

All construction products must be handled properly. Safety Data Sheets (SDS) are available and users should acquaint themselves with this information. Carefully read detailed precaution statements on product labels and the SDS before use.

### Installation

HYDRODUCT<sup>®</sup> 660 can be placed over waterproofing membranes, concrete or wood providing job site conditions allow the composite to remain as placed. Additional ballast consideration should be given in high wind exposures. Abut all edges tightly with the excess geotextile placed over the adjacent roll in shingle fashion.

To secure HYDRODUCT<sup>®</sup> 660 around protrusions, apply PREPRUFE<sup>®</sup> Detail Tape around the protrusion in a picture frame configuration. Cut HYDRODUCT<sup>®</sup> 660 to fit snugly around the protrusion. Press HYDRODUCT<sup>®</sup> 660 core firmly into the PREPRUFE<sup>®</sup> Detail Tape.

HYDRODUCT<sup>®</sup> 660 should be covered promptly. Do not leave HYDRODUCT<sup>®</sup> 660 exposed to sunlight for more than two weeks. Motor vehicles, construction equipment or other trades should not be allowed directly on the HYDRODUCT<sup>®</sup> 660.

## Supply

| HYDRODUCT <sup>®</sup>            |  |
|-----------------------------------|--|
| COMPLEMENTARY MATERIALS           |  |
| Roll size                         | 4 ft x 50 ft (1.2 m x 15.2 m) 200 ft <sup>2</sup> (18.6 m <sup>2</sup> ) |
| Packaging                         | 6 rolls/pallet   |
| Weight                            | 54lbs (24.4 kg)/roll   |
| PREPRUFE <sup>®</sup> Detail Tape | 2 in. x 50 ft (50 mm x 15 m) roll/16 rolls per carton                    |

## Physical Properties

| PROPERTY                 | TYPICAL VALUE  | TEST METHOD |
|--------------------------|--|-------------|
| GEOTEXTILE               |  |             |
| Drainage Core            |  |             |
| Thickness                | 0.40 in. (10 mm) nominal                                   | ASTM D1777  |
| Compressive strength     | 18,000 lbs/ft <sup>2</sup> (862 kPa)                       | ASTM D6364  |
| Flow rate (gradient 1.0) | 21 gal/min./ft <sup>2</sup> (261 L/min./m <sup>2</sup> )   | ASTM D4716  |
| Tensile strength         | 205 lbs (912 N)  | ASTM D4632  |
| Apparent opening size    | 80 U.S. sieve (0.177 mm)                                   | ASTM D4751  |
| Flow rate                | 100 gal/min./ft <sup>2</sup> (4075 L/min./m <sup>2</sup> ) | ASTM D4491  |
| CBR puncture             | 580 lbs (2.58 kN)  | ASTM D6241  |

We hope the information here will be helpful. It is based on data and knowledge considered to be true and accurate, and is offered for consideration, investigation and verification by the user, but we do not warrant the results to be obtained. Please read all statements, recommendations, and suggestions in conjunction with our conditions of sale, which apply to all goods supplied by us. No statement, recommendation, or suggestion is intended for any use that would infringe any patent, copyright, or other third party right.

HYDRODUCT, PREPRUFE, PROCOR, and BITUTHENE are trademarks, which may be registered in the United States and/or other countries, of GCP Applied Technologies, Inc. This trademark list has been compiled using available published information as of the publication date and may not accurately reflect current trademark ownership or status.

© Copyright 2021 GCP Applied Technologies, Inc. All rights reserved.

GCP Applied Technologies, 20 Moores Road, Malvern, PA 19355, USA.  
GCP Canada, Inc., 294 Clements Road, West, Ajax, Ontario, Canada L1S 3C6

This document is only current as of the last updated date stated below and is valid only for use in the United States. It is important that you always refer to the currently available information at the URL below to provide the most current product information at the time of use. Additional literature such as Contractor Manuals, Technical Bulletins, Detail Drawings and detailing recommendations and other relevant documents are also available on [www.gcpat.com](http://www.gcpat.com). Information found on other websites must not be relied upon, as they may not be up-to-date or applicable to the conditions in your location and we do not accept any responsibility for their content. If there are any conflicts or if you need more information, please contact GCP Customer Service.

Last Updated: 2026-06-23

[gcpat.com/solutions/products/hydroduct-drainage-composite/hydroduct-660](http://gcpat.com/solutions/products/hydroduct-drainage-composite/hydroduct-660)