

HYDRODUCT[®] 220

BITUTHENE[®] HRA
PROTECTION G
(OR PROTECTION P)

BITUTHENE[®] MEMBRANE
(SEE NOTE 1)

BITUTHENE[®] LIQUID
MEMBRANE

BITUTHENE[®] HRA
FABRIC

BITUTHENE[®] HRA

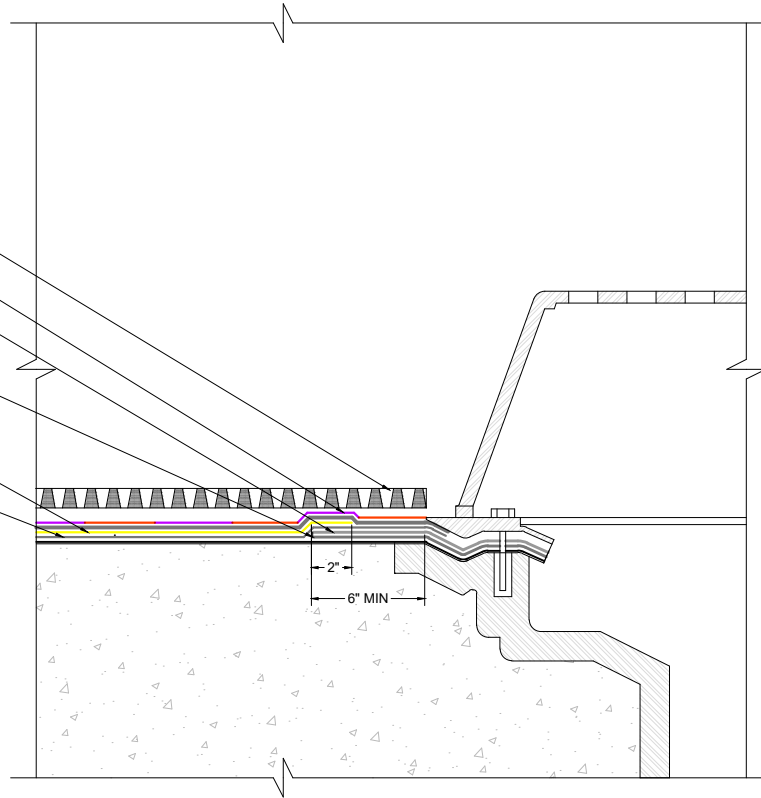

NOTES:

1. FOR PERMANENTLY EXPOSED AREAS, BITUTHENE[®] HRA CAP IS ALSO ACCEPTABLE AS A PROTECTION COURSE
2. OVERBURDEN SYSTEM BY DESIGN



DRAIN DETAIL (BITUTHENE[®] MEMBRANE IN FLANGE)

BITUTHENE[®] HRA WATERPROOFING SYSTEM

DRAWING: HRA-005B

SCALE: NOT TO SCALE

EFFECTIVE DATE: 01-30-2026

SUPERCEDES: N/A