

VYCORNER™ OR CORNER
PATCH RECOMMENDED
(SEE VCRDET-507 OR VCRDET-504 FOR OPTIONS)

MECHANICALLY FASTEN AS
NECESSARY IN CORNERS
THROUGH VYCOR® PLUS

PERM-A-BARRIER® S100
SEALANT OR COMPATIBLE
SEALANT TERMINATION

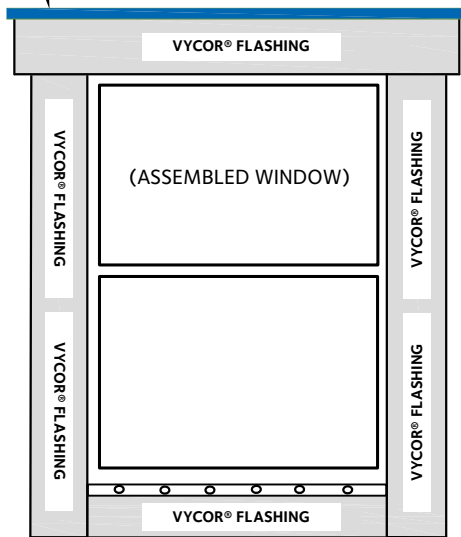

DO NOT FLASH
OVER BOTTOM NAILING FLANGE

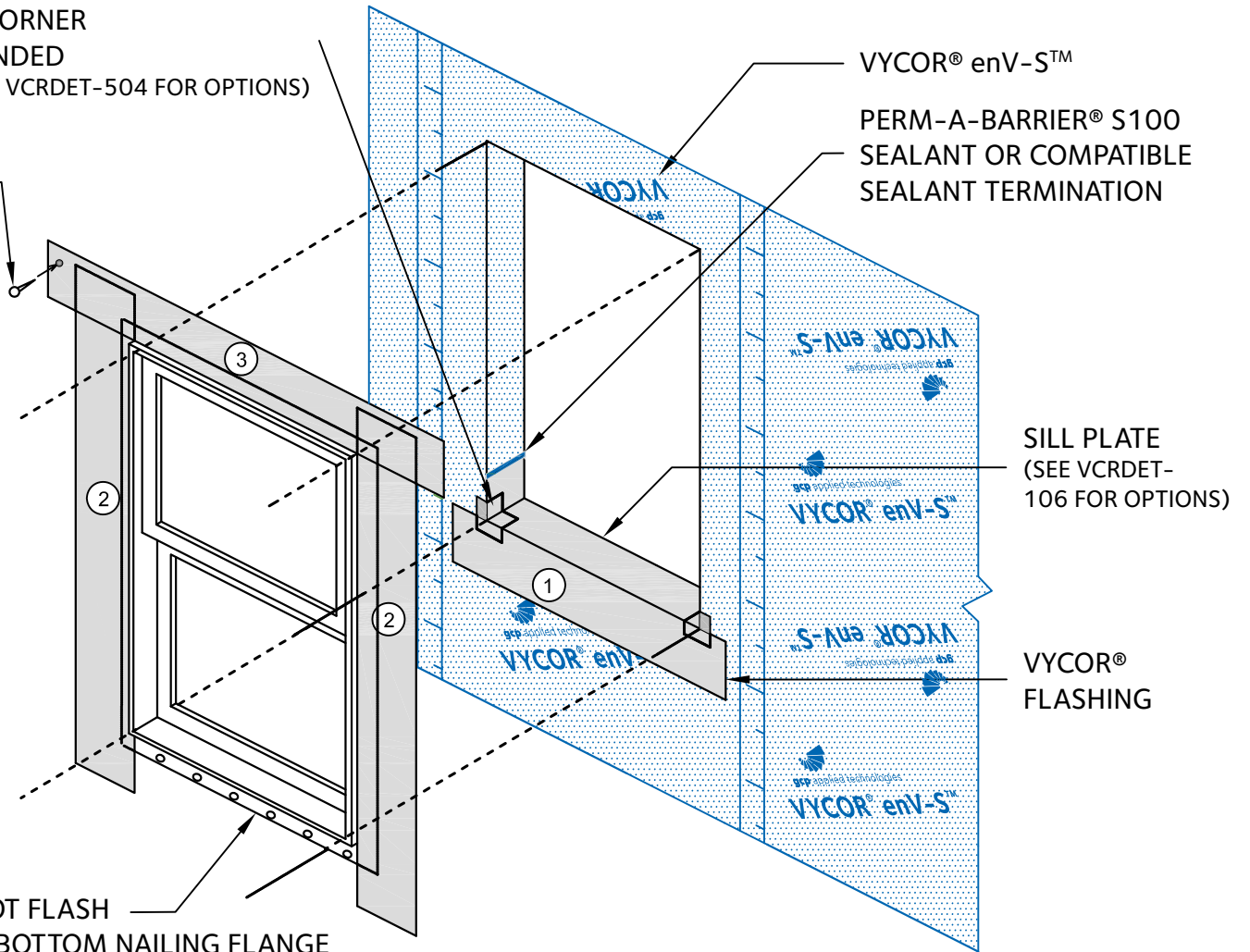

NOTES:

- A. VISIT GCPAT.COM FOR THE MOST CURRENT DETAILS, INSTALLATION VIDEO AND PRODUCT DATA SHEETS
- B. RIPCORD® CAN BE REMOVED FROM VYCOR® FLASHING FOR EASE OF INSTALLATION
- C. INSTALL VYCOR® FLASHING IN ORDER AS SHOWN BY NUMBERS
- D. DETAIL RELEVANT FOR ALL VYCOR® FLASHINGS
- E. INSTALL VYCOR® enV-S™ VERTICALLY OR HORIZONTALLY TO FORM WATER SHEDDING LAPS
- F. INSTALL PERM-A-BARRIER® S100 OR COMPATIBLE SEALANT TO TOP LEADING EDGE OF HEAD FLASHING AND ALL NON WATER SHEDDING EDGES



gcpat.com

FLANGED WINDOW

FLASHING INSTALLATION AFTER VYCOR® enV-S™

VYCOR® SELF-ADHERED FLASHING

Drawing: VCRENVS-100

Scale: Not to scale

Effective Date: 08/04/19

Supersedes: NEW