

**FOR SLABS OR WALLS
(LESS THAN 2 FEET THICK)**

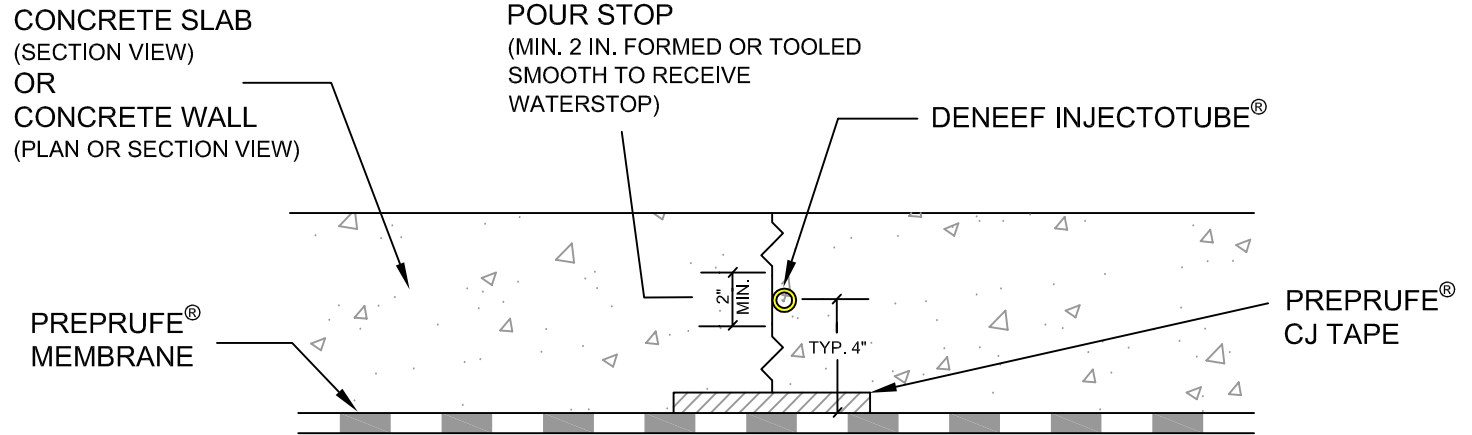

**FOR SLABS OR WALLS
(GREATER THAN 2 FEET THICK)**

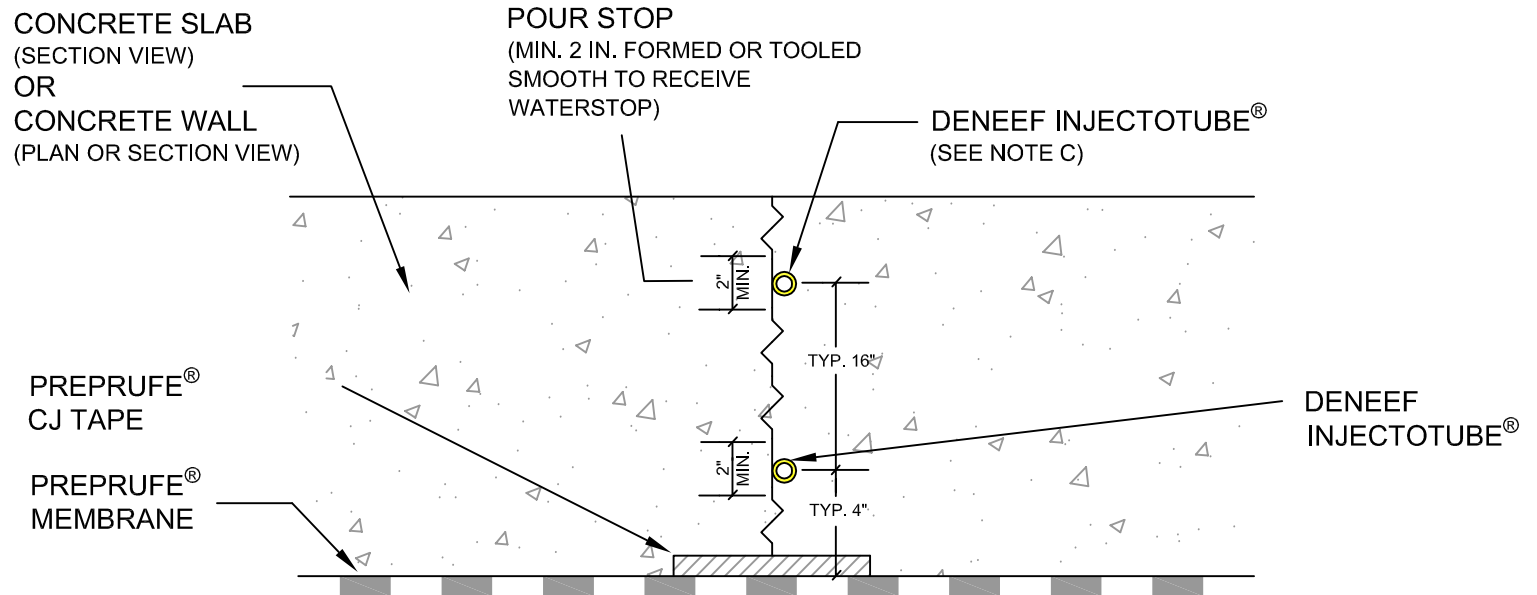

- NOTES: A. GCP MAY REQUIRE AN ALTERNATE GCP INJECTABLE WATERSTOP BASED ON DESIGN CONDITIONS
 B. POSITION INJECTOTUBE 4 INCHES FROM THE PREPRUFE MEMBRANE
 C. CONCRETE SLABS OR WALLS GREATER THAN 2 FEET IN THICKNESS, AN ADDITIONAL INJECTOTUBE 16 INCHES ABOVE THE FIRST INJECTOTUBE RECCOMENDED
 D. ENSURE INJECTOTUBE HAS A MINIMUM 3 INCHES OF CONCRETE COVER AND SPACING BETWEEN RUNS OF INJECTOTUBE ARE A MIN. OF 12 IN.



**CONSTRUCTION JOINT - (OPTION-B)
PREPRUFE® WATERPROOFING SYSTEM**

DRAWING: PRE-042-B

SCALE: Not to scale

EFFECTIVE DATE: 07/01/2016

SUPERCEDES: NEW

Construction Joints (Option B)

Prior to Membrane Installation, Review the Preprufe®
Data Sheet



Surface Prep

All surfaces must be sound and solid to eliminate movement during the concrete pour. Substrate must be regular and smooth with no gaps or voids greater than 0.5 in (15 mm). The surface should also be free from loose aggregate and sharp protrusions as outlined in the Preprufe® Data Sheet section on Surface Preparation.

Detailing

1. Install Preprufe membrane according to standard horizontal and vertical application instructions on the Preprufe data sheet found at www.gcpat.com.
2. Preprufe CJ Tape should be applied to the surface of the Preprufe membrane and centered along the line of all contraction (control) and construction joints.
3. Remove release liner and roll tape to ensure good adhesion using steel or vinyl cylindrical and Vee roller.
4. Ensure and damaged tape or membrane is repaired after removal of formwork or bulkhead.

Special Notes

Preprufe membranes should not be used in areas where they will be permanently exposed to sunlight, weather or traffic. Protect membrane from sunlight as quickly as possible after installation.

Ensure Deneef Injectotube® waterstop is encapsulated with 3 in (75 mm) of concrete cover minimum. Apply Deneef Injectotube® waterstop according to the installation instructions found on the data sheet.

For slab designs that will exceed 24 in (600mm) in thickness, an additional Injectotube installed 16 in (400 mm) above the first Injectotube should be considered.

GCP may require an alternative GCP injectable waterstop based on design conditions, at GCP's discretion.