

PLAN VIEW

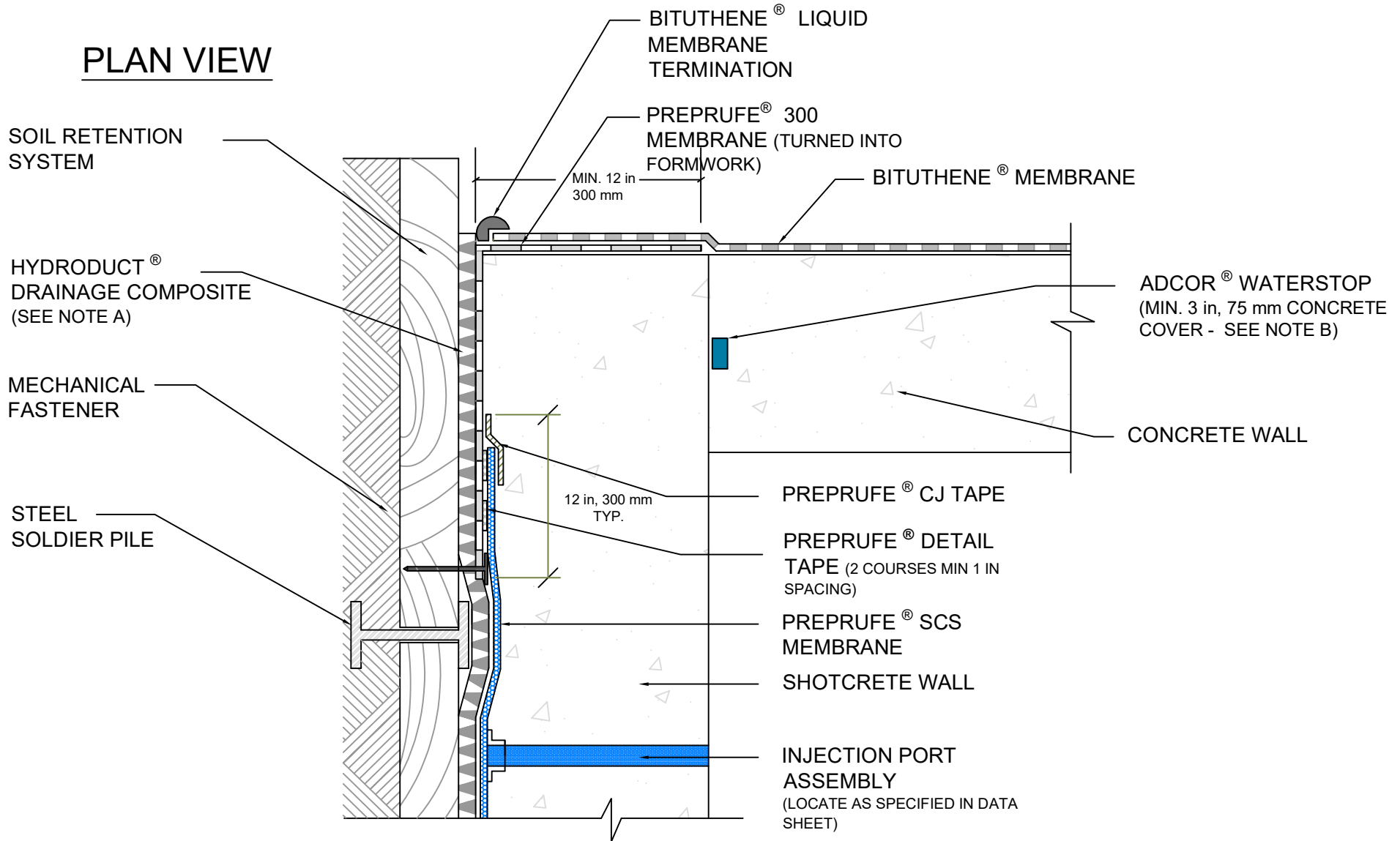

- NOTES: A) IF HYDRODUCT® IS USED AS PART OF THE DRAINAGE SYSTEM, 6 MIL, 1.5 mm POLY IS REQUIRED BETWEEN THE HYDRODUCT® AND THE PREPRUFE® SCS MEMBRANE
 B) GCP MAY REQUIRE AN ALTERNATE GCP WATERSTOP BASED ON DESIGN CONDITIONS



TIE-IN TO BITUTHENE® (WALL) PREPRUFE® SCS WATERPROOFING SYSTEM FOR SHOTCRETE

DRAWING: SCS 006 Rev 2023

SCALE: Not to scale

EFFECTIVE DATE: 08/22/2023

SUPERCEDES: 08012016